

# CrushGrind®

## QUADRO WOOD

WOOD

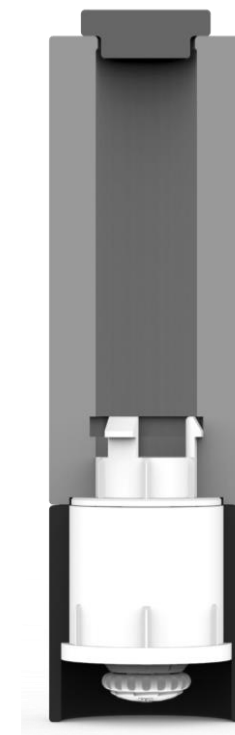
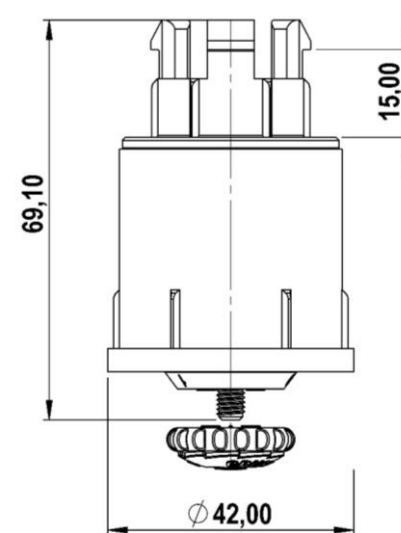

# Feature details

## 1. Easy fill

This mechanism works perfectly for 'easy fill' solutions and for upside down grinders. It is possible to think of creative ways to allow for the filling of spice with lots of versatility and freedom regarding the positioning and method for re-filling.

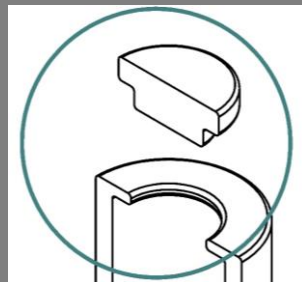

## 2. Ribs

These carefully designed ribs penetrate into the wood in order to prevent rotation of the mechanism without the use of screws.

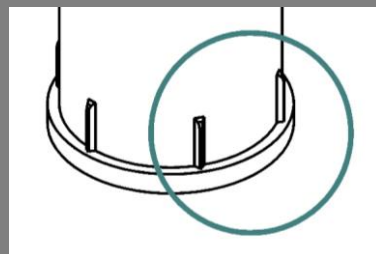

## 3. Snap-hooks

This mechanism uses snap hooks to mount inside the body easily without the need to use screws.

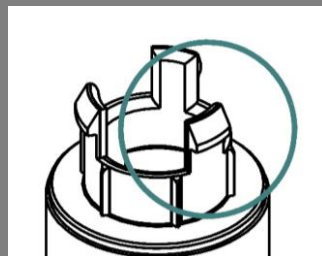

WOOD  
Integration  
guidelines

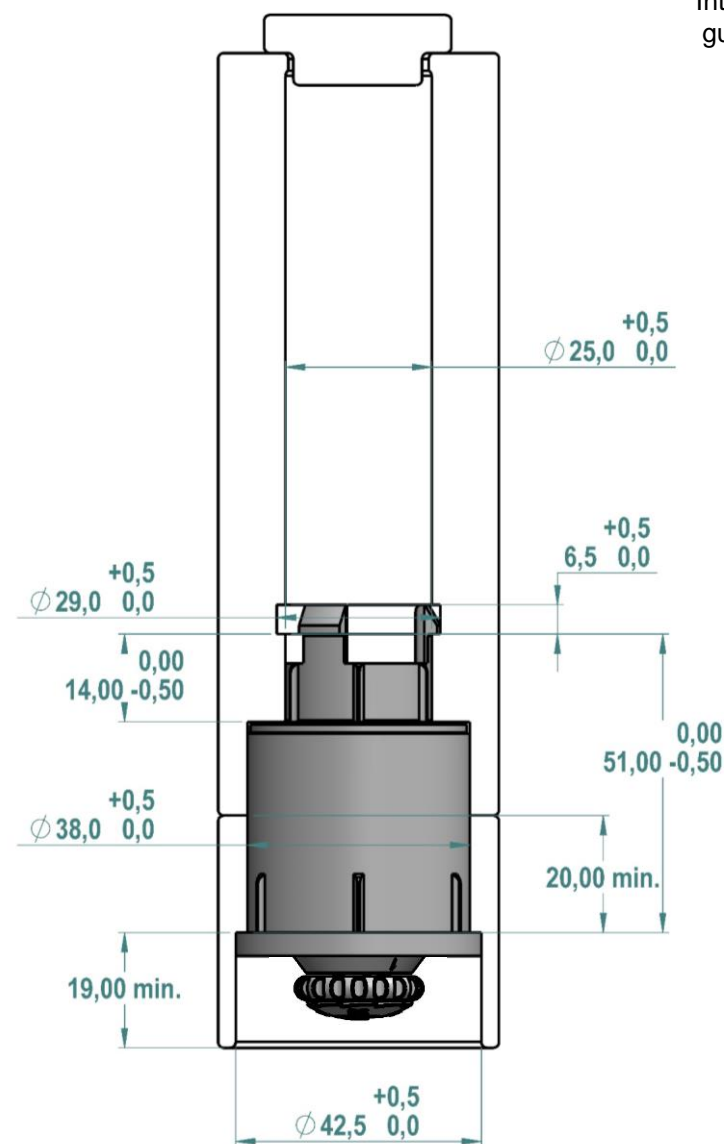

**Stopper**  
Easy fill

**Warranty**  
25 years

**Patent**  
Yes

All measurements in mm. Tolerances shown are for mounting into wooden products. Minimum 6mm wall thickness around ribs recommended for wooden products.

**CrushGrind®**  
QUADRO SHAFT

SHAFT

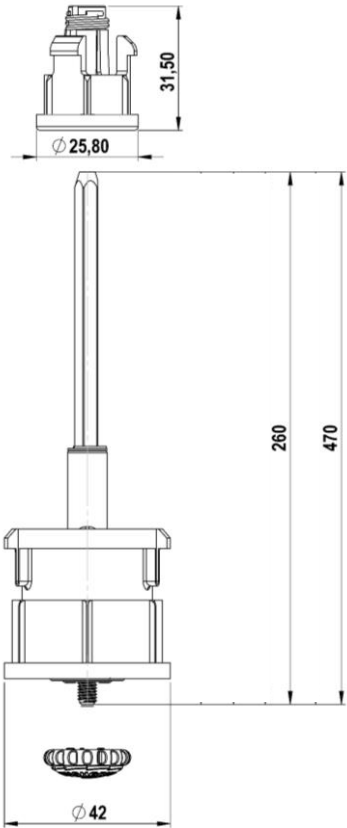

# Feature details

## 1. Stopper fixture

We developed this stopper fixture to avoid the need for a 'nut' on our mechanisms that use shafts. This stopper fixture easily integrates into the 'head' section of grinders. Simply pull off the 'head' to refill a mill - with no need to unscrew any bolt. The stopper fixture can securely hold 3Kg (min).

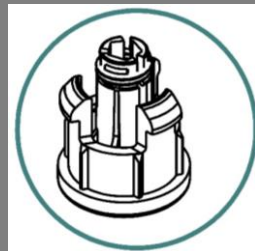

## 2. Ribs

These carefully designed ribs penetrate into wood in order to prevent rotation of the mechanism without the use of screws. When using this mechanism in plastic materials the purpose of the ribs is the same. However, the geometry of the ribs must be allowed for when designing the inner construction.

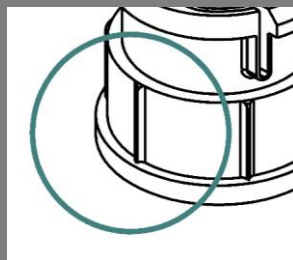

## 3. Snap-hooks

This mechanism uses snap hooks to mount inside the body easily without the need to use screws.

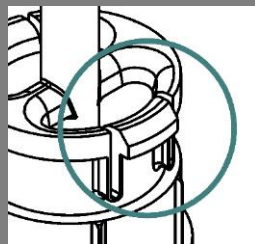

## SHAFT Integration guidelines

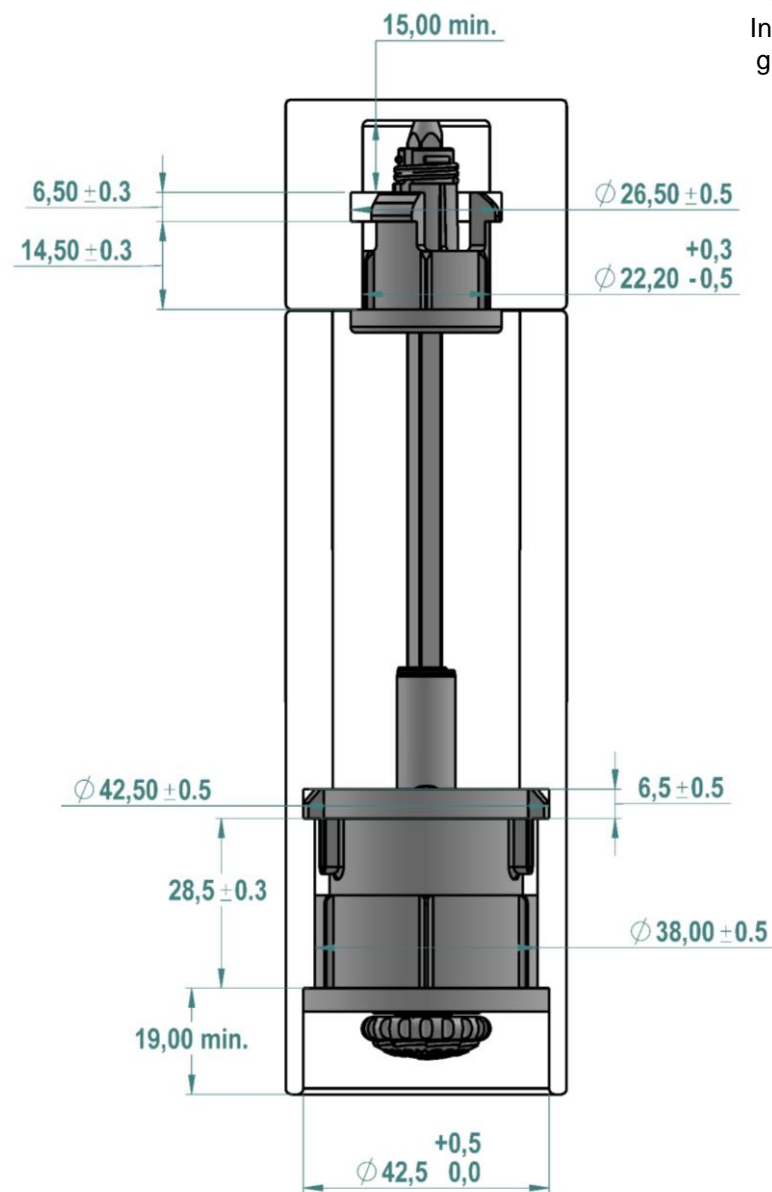

**Stopper**  
Regular

**Warranty**  
25 years

**Patent**  
Yes

All measurements in mm. Tolerances shown are for mounting into wooden products. Minimum 6mm wall thickness around ribs recommended for wooden products.

**CrushGrind®**  
QUADRO SHAFT MINI

SHAFT MINI

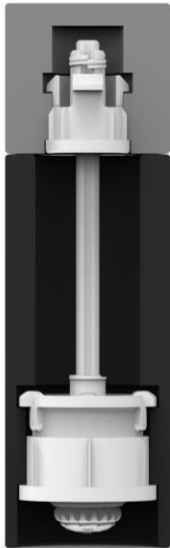
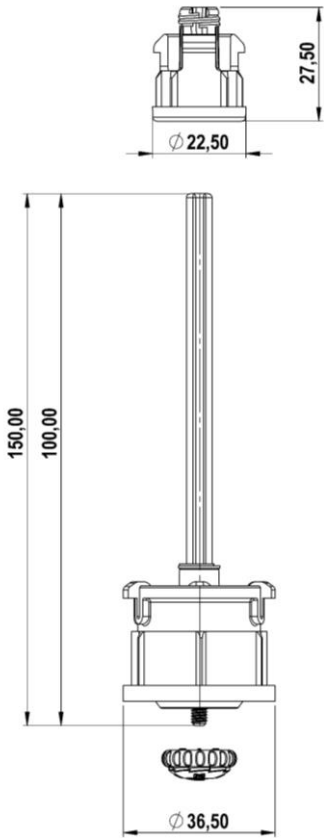

# Feature details

## 1. Mini stopper fixture

We developed this stopper fixture to avoid the need for a 'nut' on our mechanisms that use shafts. This stopper fixture easily integrates into the 'head' section of grinders. Simply pull off the 'head' to refill a mill - with no need to unscrew any bolt. The mini stopper fixture can securely hold 2Kg (min).

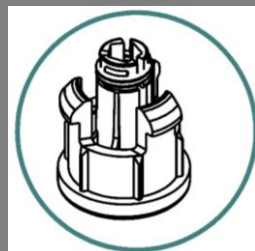

## 2. Ribs

These carefully designed ribs penetrate into wood in order to prevent rotation of the mechanism without the use of screws. When using this mechanism in plastic materials the purpose of the ribs is the same. However, the geometry of the ribs must be allowed for when designing the inner construction.

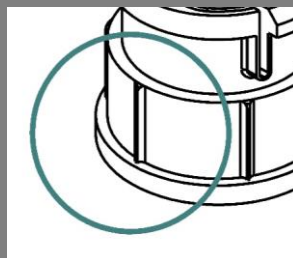

## 3. Snap-hooks

This mechanism uses snap hooks to mount inside the body easily without the need to use screws.

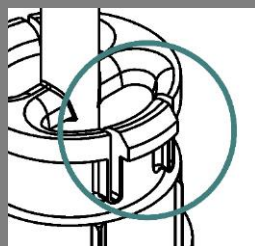

## SHAFT MINI Integration guidelines

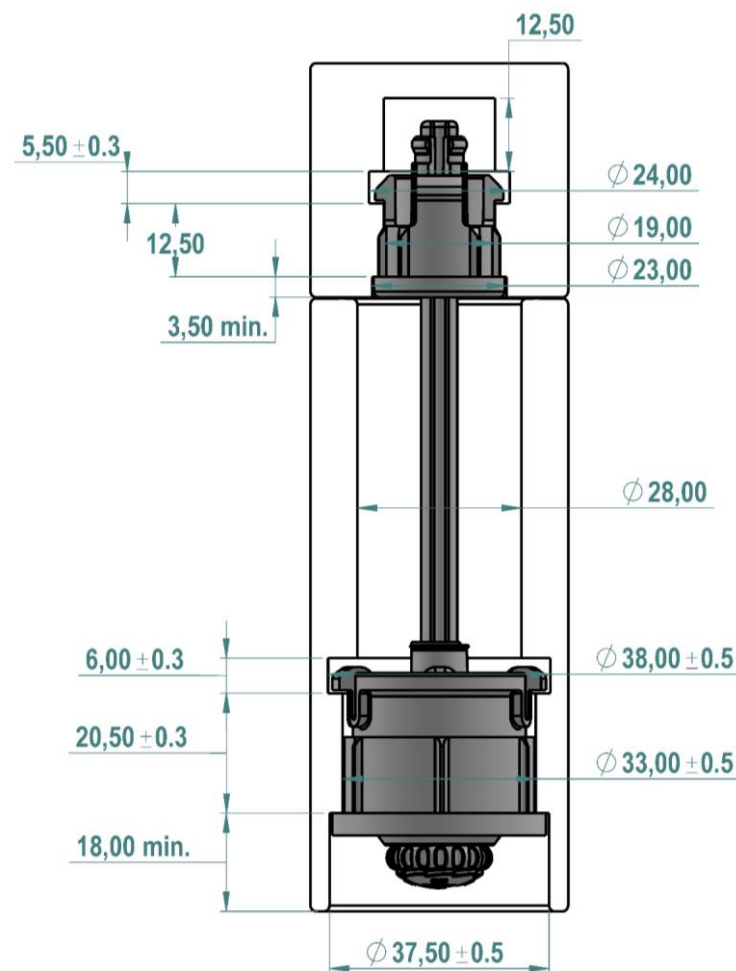

**Stopper**  
Mini

**Warranty**  
25 years

**Patent**  
Yes

All measurements in mm. Tolerances shown are for mounting into wooden products. Minimum 6mm wall thickness around ribs recommended for wooden products.